



**IMPORTANT – THIS COMMUNICATION AFFECTS YOUR PROPERTY**

## **COUNCIL OF THE ISLES OF SCILLY**

Town Hall, The Parade, St Mary's TR21 0LW  
Telephone: 01720 424455 – Email: [planning@scilly.gov.uk](mailto:planning@scilly.gov.uk)

Town and Country Planning Act 1990  
Town and Country Planning (Development Management Procedure) Order 2010

---

### **PERMISSION FOR DEVELOPMENT**

**Application No:** P/19/035/HH

**Date Application Registered:** 2nd July 2019

**Applicant:** Mr Michael Green  
Tregea  
4 Bay View Terrace  
Telegraph Road  
Porth Mellon  
St Mary's  
Isles Of Scilly  
TR21 ONE

**Site Address:** Tregea 4 Bay View Terrace Telegraph Road Porth Mellon St Mary's

**Proposal:** Erection of a garden shed.

In pursuance of their powers under the above act, the Council hereby **PERMIT** the above development to be carried out in accordance with the following Conditions:

**C1 The development hereby permitted shall be begun before the expiration of three years from the date of this permission.**

Reason: In accordance with the requirements of Section 91 of the Town and Country Planning Act 1990 (as amended by Section 51 of the Planning and Compulsory Purchase Act 2004).

**C2 The development hereby permitted shall be carried out in accordance with the approved details only including:**

- **Location Plan;**
- **Site Plan; and**
- **Proposed Elevations;**

**These are stamped as APPROVED**

Reason: For the clarity and avoidance of doubt and in the interests of the character and appearance of the Conservation Area, Area of Outstanding Natural Beauty and Heritage Coast in accordance with Policy 1 of the Isles of Scilly Local Plan 2005.

**C3 The building, hereby approved, shall only be used for purposes of a non-habitable, non-commercial ancillary storage use to the residential dwelling known as 'Tregea' at 4 Bay View Terrace, and within the red line application site area, and shall not be used for any other purpose. It shall specifically not be used as a separate dwellinghouse or for any commercial purposes and shall not be let, sold or otherwise disposed of separately from the existing residential unit of**

**'Tregea' at 4 Bay View Terrace.**

Reason: To safeguard the amenity and character of the surrounding area and to control the character and volume of traffic attracted to the site.

**Further Information**

1. In dealing with this application, the Council of the Isles of Scilly has actively sought to work with the applicants in a positive and proactive manner, in accordance with paragraph 38 the National Planning Policy Framework 2018.

Signed

A handwritten signature in black ink, appearing to read 'J. H. ...'.

Senior Officer, Planning and Development Management

**DATE OF ISSUE:** 23<sup>rd</sup> August 2019



# COUNCIL OF THE ISLES OF SCILLY

Planning Department  
Town Hall, The Parade, St Mary's, Isles of Scilly, TR21 0LW  
☎01720 424455  
✉planning@scilly.gov.uk

Dear Mr Michael Green

## Please sign and complete this certificate.

This is to certify that decision notice: P/19/035/HH and the accompanying conditions have been read and understood by the applicant: Mr Michael Green.

- 1. Development of the approved plans:** Erection of a garden shed at: Tregea 4 Bay View Terrace Telegraph Road Porth Mellon St Mary's, will commence **on:** (insert date) [Click or tap to enter a date.](#)
- ~~2. I am/we are aware of any conditions that need to be discharged before works commence.~~
- ~~3. I/we will notify the Planning Department in advance of commencement in order that any pre-commencement conditions can be discharged.~~

**Print Name:** [Click or tap here to enter text.](#)

**Signed:**

**Date:** [Click or tap to enter a date.](#)

Please sign and return to the **above address** as soon as possible.

SOUTH WEST ELEVATION

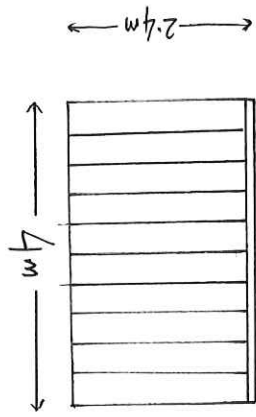

FIBRE GLASS ROOF  
ALUMINIUM CLADDING

NORTH EAST ELEVATION

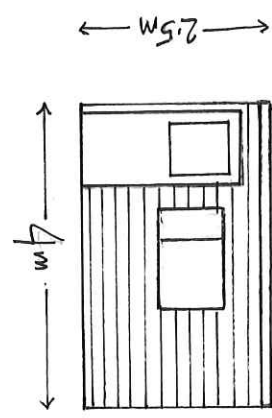

PVC WINDOWS  
PVC DOOR  
TIMBER EFFECT CLADDING

SOUTH EAST ELEVATION

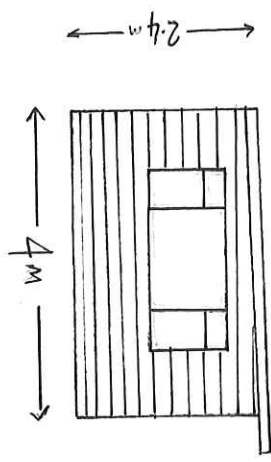

NORTH WEST ELEVATION

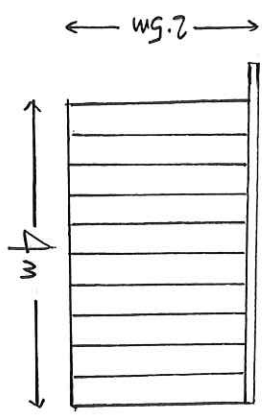

**APPROVED**

MICHAEL GREEN  
PROPOSED GARDEN SHED  
4 BAY VIEW TERRACE  
ST MARY'S  
SCALE 1:50

RECEIVED BY THE  
PLANNING DEPARTMENT

02 JUL 2019

Original

19 / 035

## Location Plan of 4 Bay View Terrace

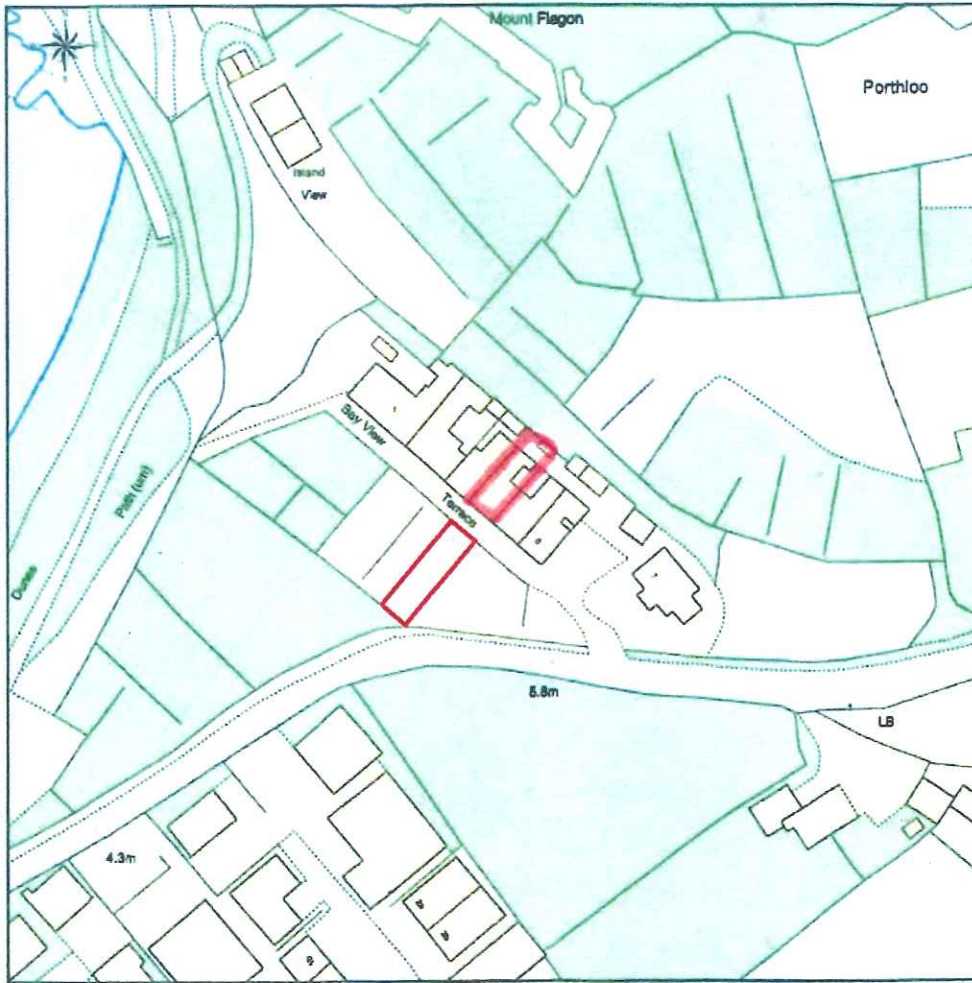

This Plan includes the following Licensed Data: OS MasterMap Colour PDF Location Plan by the Ordnance Survey National Geographic Database and incorporating surveyed revision available at the date of production. Reproduction in whole or in part is prohibited without the prior permission of Ordnance Survey. The representation of a road, track or path is no evidence of a right of way. The representation of features, as lines is no evidence of a property boundary. © Crown copyright and database rights, 2016 Ordnance Survey 0100031673

0m 20m 40m 60m 80m 100m

Scale: 1:1250, paper size: A4

Location Plan  
4 Bay View Terrace  
Porthmeillon  
St. Mary's  
Isles of Scilly  
\TR21 ONE

**APPROVED**

plans ahead by emapsite



APPROVED BY THE  
PLANNING DEPARTMENT  
02 JUL 2019

original

19 / 035

### Site Plan of Tr210NE

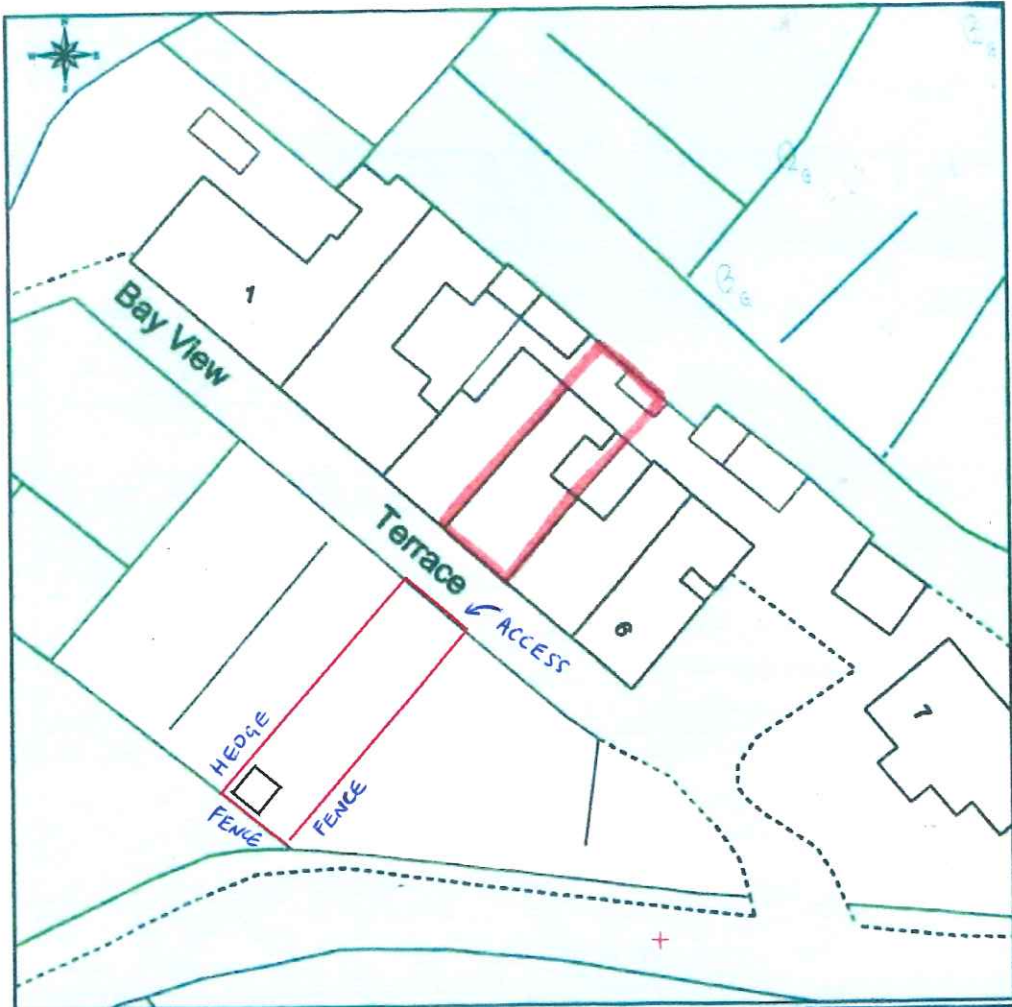

This Plan includes the following Licensed Data: OS MasterMap Colour PDF Site Plan/Block Plan by the Ordnance Survey National Geographic Database and incorporating surveyed revision available at the date of production. Reproduction in whole or in part is prohibited without the prior permission of Ordnance Survey. The representation of a road, track or path is no evidence of a right of way. The representation of features, as lines is no evidence of a property boundary. © Crown copyright and database rights, 2018. Ordnance Survey 0100031873

0m 5m 10m 15m 20m 25m 30m 35m 40m

Scale: 1:500, paper size: A4

Site Plan  
4 Bay View Terrace  
Porthmeillon  
St. Mary's  
Isles of Scilly  
TR21 0NE

**APPROVED**

plans ahead by **emasite**