

Information is given as a guide only and its accuracy cannot be guaranteed.

PLEASE NOTE: This plan ONLY shows assets owned by Western Power Distribution. Electricity assets owned by IDNO's (Independent Network Operators) MAY be present in this area.

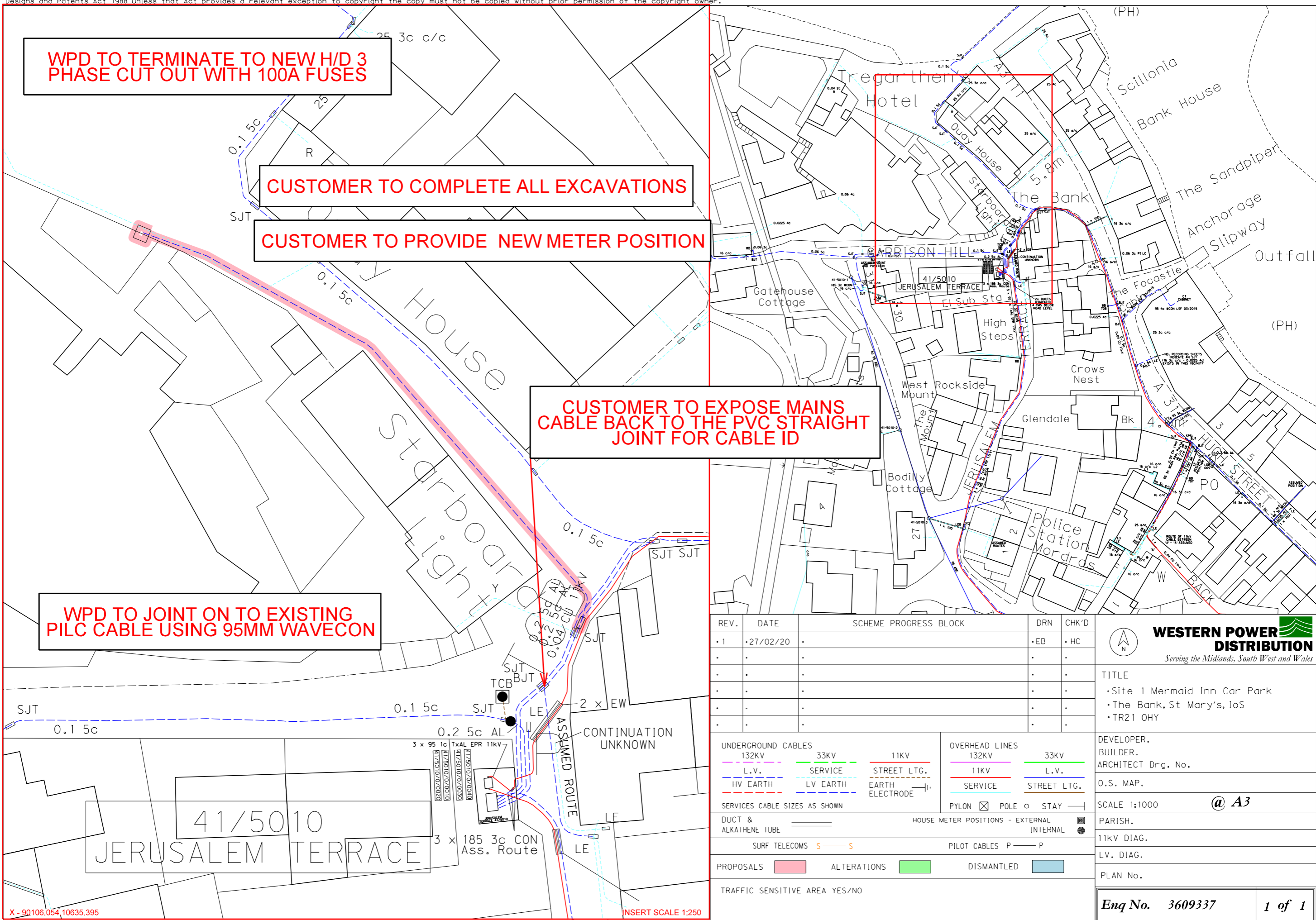

WPD TO TERMINATE TO NEW H/D 3 PHASE CUT OUT WITH 100A FUSES

CUSTOMER TO COMPLETE ALL EXCAVATIONS

CUSTOMER TO PROVIDE NEW METER POSITION

CUSTOMER TO EXPOSE MAINS CABLE BACK TO THE PVC STRAIGHT JOINT FOR CABLE ID

WPD TO JOINT ON TO EXISTING PILC CABLE USING 95MM WAVECON

| REV. | DATE | SCHEME PROGRESS BLOCK | DRN | CHK'D |
|------|------------|-----------------------|------|-------|
| • 1 | • 27/02/20 | | • EB | • HC |
| • | • | | • | • |
| • | • | | • | • |
| • | • | | • | • |
| • | • | | • | • |
| • | • | | • | • |

WESTERN POWER DISTRIBUTION
Serving the Midlands, South West and Wales

TITLE
• Site 1 Mermaid Inn Car Park
• The Bank, St Mary's, IOs
• TR21 OHY

| | | | | |
|-------------------------------------|-----------------------------|---|--|-----------------------------|
| UNDERGROUND CABLES 132KV L.V. | 33KV SERVICE LV EARTH | 11KV STREET LTG. EARTH ELECTRODE | OVERHEAD LINES 132KV 11KV SERVICE | 33KV L.V. STREET LTG. |
| SERVICES CABLE SIZES AS SHOWN | | | PYLON ☒ POLE ○ STAY — | |
| DUCT & ALKATHENE TUBE | | HOUSE METER POSITIONS - EXTERNAL INTERNAL | | |
| SURF TELECOMS S — S | | PILOT CABLES P — P | | |
| PROPOSALS | ALTERATIONS | DISMANTLED | | |
| TRAFFIC SENSITIVE AREA YES/NO | | | | |

DEVELOPER.
BUILDER.
ARCHITECT Drg. No.
O.S. MAP.
SCALE 1:1000 @ A3
PARISH.
11KV DIAG.
LV. DIAG.
PLAN No.

Enq No. 3609337 1 of 1

X - 90106.054, 10635.395

INSERT SCALE 1:250