

ORIGINAL EXTENSION PROPOSAL

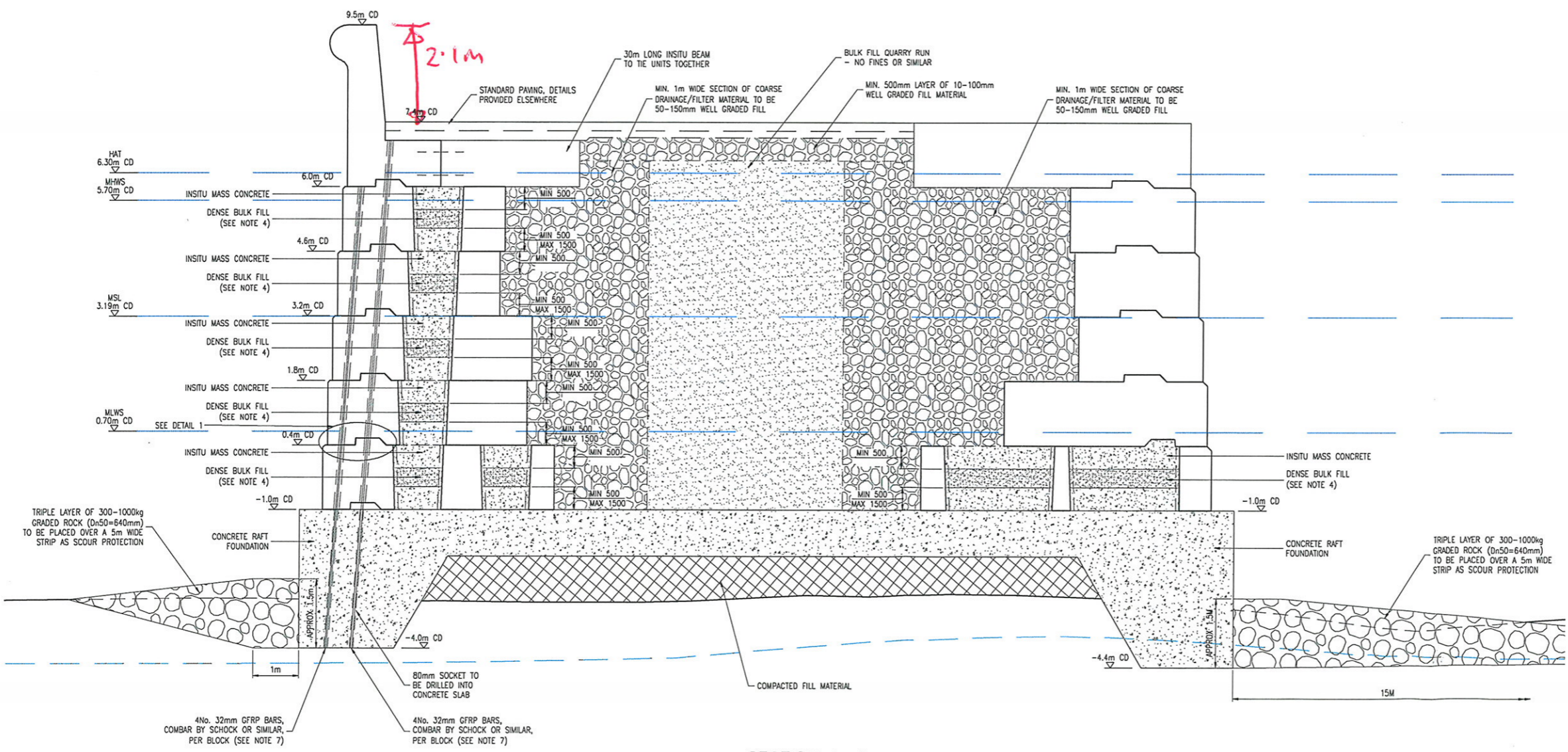

- Notes:
- All dimensions in millimetres unless otherwise stated.
  - All levels in metres to Chart Datum unless otherwise stated.
  - In situ mass concrete shall be as mix no. 3 of the specification.
  - Dense bulk fill material shall be a clean granular material as type 6N of the highways specification. Material shall have a bulk density of 2150kg/m<sup>3</sup> or higher. Material may be substituted for Mass Concrete fill as mix no. 1 of the specification.
  - Back fill including drainage/filter material to have a bulk density of greater than 2150kg/m<sup>3</sup> and to be compacted in layers to achieve a measured  $\phi$  of greater than 40'.
  - For section B-B see drawing E-1102-SM. For section C-C see drawing E-1103-SM.
  - GFRP bars shall be installed as follows:  
Chainage 0 to Chainage 53 8No. bars per 1.43m unit drilled into concrete base.  
Chainage 53 to Chainage 100 6No. bars per 1.43m unit drilled through concrete base and into rock as shown on section B-B.  
Chainage 100 to Chainage 130 4No. bars per 1.43m unit drilled through concrete base and into rock as shown on section C-C.

Rev	By	Chkd	Apprd	Date	Description
6	GR	GR	GR	07/19	NOTE 7 REWORKED GFRP BARS MARKED FOR REMOVAL
5	MC	GR	GR	02/19	SECTION MARKED TO SHOW REVERSED SCOUR PROTECTION
4	MC	GR	GR	02/19	PLAN AND SECTION REWORKED
3	GR	GR	GR	02/19	NO. OF BARS PER BLOCK ADDED NOTE 7 ADDED
2	GR	GR	GR	02/19	BLOCK SIZE CHANGED, BOTTOM BLOCK REPLACED WITH HEAVY MASS CONCRETE
1	GR	GR	GR	02/19	PRELIMINARY

Client

**Birse Coastal**

Halcrow Group Limited  
Deasway Technology Centre, Wilmow Road, HandwORTH, CHESTER, CH69 3PB  
Tel: +44(0)1625 545456 Fax: +44(0)1625 549225  
www.halcrow.com

**Halcrow**

Project ISLES OF SCILLY LINK HARBOUR WORKS (DCSCDD) ST MARY'S

Drawing EXTENSION REAR WALL SECTION A-A

Drawn by: GJS Date: MAR 09  
Checked by: GJR Date: MAR 09  
Approved by: GJR Date: MAR 09

Drawing No. E-1101-SM Revision 6  
Drawing Scale: AS SHOWN AT A1

PRELIMINARY