

T J HIRON, MRICS
Clowdisley
Golf Club Lane,
St. Mary's,
Isles of Scilly
TR21 0NF

01720422563
terry.hiron@virgin.net

9th September 2014

Attn Planning Officer,
Council of the Isles of Scilly

Attn. Lisa Walton

Dear Ms Walton,

RE: Lawful Development at White Cottage, Porthloo, St. Mary's.

Thank you for your letter of 5th September. I am afraid that the owner, Mr. Hicks, is away from the Islands at the present time so I cannot give you evidence of its' use from 2012.

With regard to the erection, I would suggest it is at least 50 or 60yrs old and I enclose a plan of the land supplied by the Duchy of Cornwall in 1978 before the freehold interest was purchased. I also enclose a copy of the ordinance survey plan dated 1980. You will see that the building is shown to exist before that time.

With regard to the applicant's interest, he is the owner of the freehold interest as stated in S5 of the application form. He occupies White Cottage.

I will contact you or ask Mr. Hicks to contact you regarding the use since 2012 as soon as possible.

Yours sincerely,

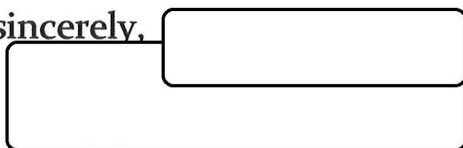

T J Hiron, MRICS.

WRAFT PL

Manor/Estate

ISLES OF SCILLY

Edition/s

1978

Sheet No/s

SV 9011 - 9111

Parish/s

ST. MARY'S

TENANCY 45

Scale/s

1 : 2500

Ref:

SMM : 2759

Date:

SEPTEMBER '84

Based upon the Ordnance Survey Map with the permission of the Controller of Her Majesty's Stationery Office Crown Copyright reserved

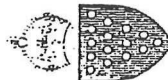

Duchy of Cornwall Office
10 Buckingham Gate
London
SW 1E 6LA

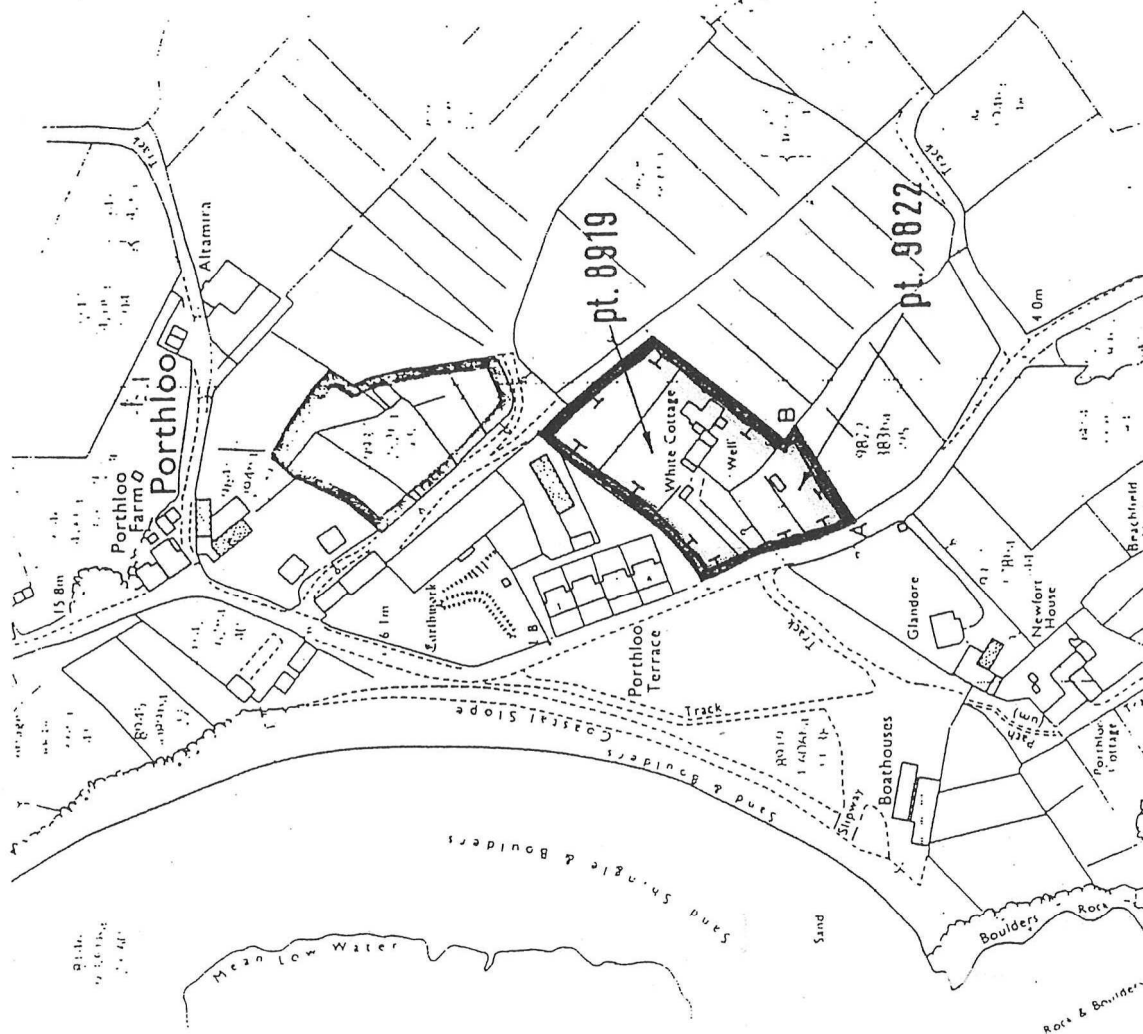
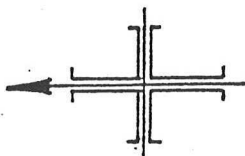

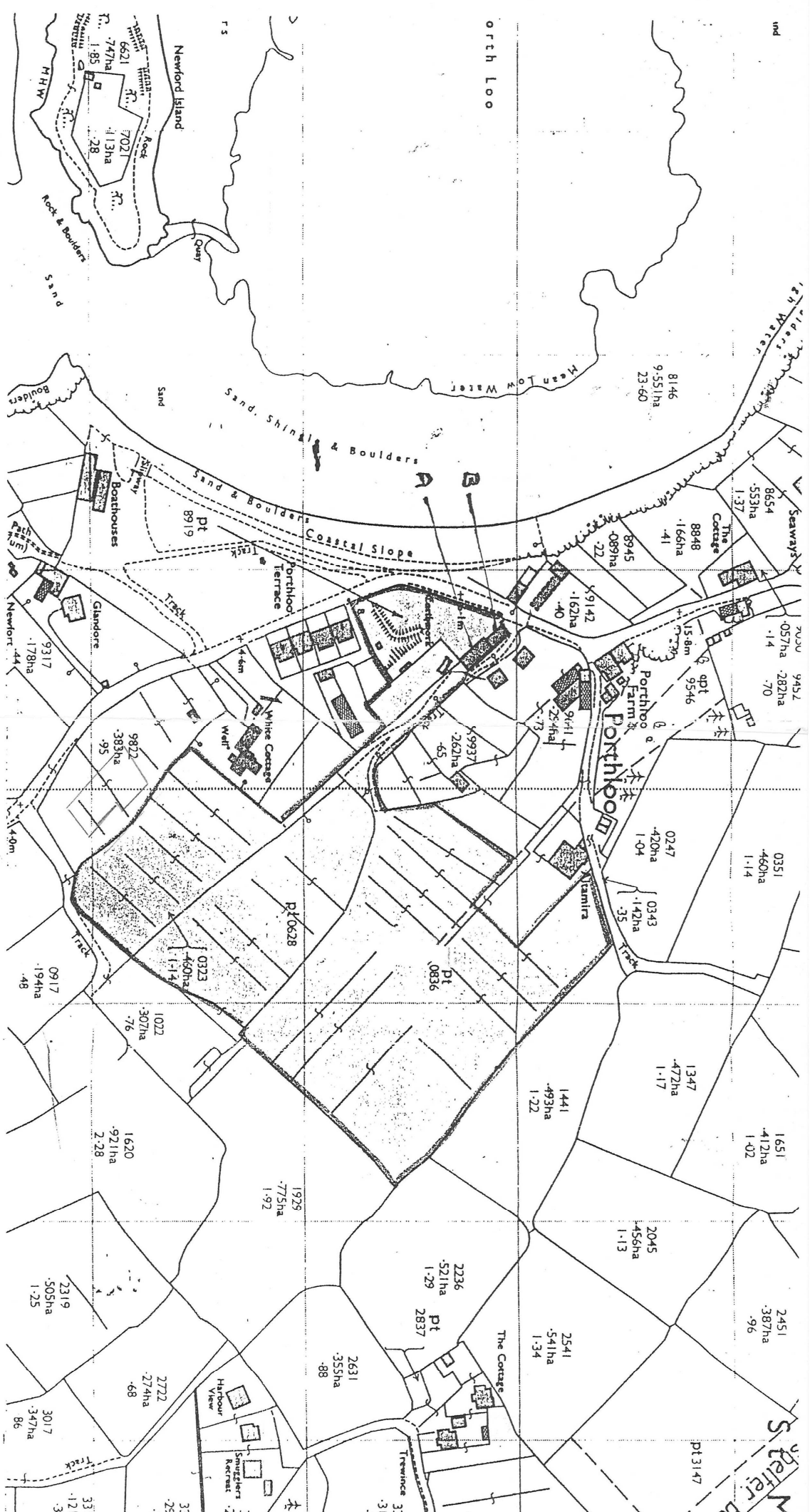

Based upon the Ordnance Survey Map
with the permission of the Controller
of Her Majesty's Stationery Office
Crown copyright reserved

Edition/s	1 980
Sheet No/s	SV 9011 9111
Parish/s	ST. MARY'S
District	

Manor/Estate
ST. MARY'S
400x2.5M

Scale/s	1 / 2500 1:2500
Ref:	SJD
Date:	OCT 199