

- NOTES:**
- Surface water from the site is discharging to existing ditch at assumed level. Survey of the ditch to be carried out and the levels to be confirmed.
 - Surface water sewers design to accommodate storm event 1 in 30 years for whole site (Phase 1 & Phase 2).
 - Invert levels of outfall sewers are to be checked before commencing drainage works.
 - All materials and workmanship in connection with non adoptable drainage works to comply with BS EN 752 "Drain and Sewer Systems Outside buildings" and the "Building Regulations 2002, Section H - Drainage and Waste Disposal".
 - Private drainage to be constructed in accordance with BS 8301 1985 "Building Drainage" & Section H of the Building Regulations 2002 and any other Specification required by the contract.
 - Private drainage to be 100 dia. unless shown otherwise. Pipes to be laid and bedded in accordance with the manufacturers instructions. All pipes on adoptable laterals beneath public highway to be min.150 dia. extra strength vitrified clay.
 - Manhole covers are indicative and should be adjusted to suit finished levels. Covers should be fixed parallel to kerb lines.
 - Covers and frames to be :
 - Yards and Roads - Class D400 (ductile iron to BS EN 124).
 - Other trafficked areas - Class C250 (ductile iron to BS EN 124).
 - Non trafficked areas - Class B125 (ductile iron to BS EN 124).
 - Where the crown of the pipe is within 300mm of the underside of the building slab, concrete encasement should be used integral with the slab.
 - Sulphate Resisting concrete shall be used in accordance with BRE Special Digest Parts 1-4, if required by the soil conditions.
 - The symbols on the drainage key do not indicate the shape nor size of the feature to which they relate.

© 2014 RPS Group

Notes

- This drawing has been prepared in accordance with the scope of RPS's appointment with its client and is subject to the terms and conditions of that appointment. RPS accepts no liability for any use of this document other than by its client and only for the purposes for which it was prepared and provided.
- If received electronically it is the recipients responsibility to print to correct scale. Only written dimensions should be used.
- This drawing should be read in conjunction with all other relevant drawings and specifications.

Proposed Engineering Layout Phase 2
Scale 1:250

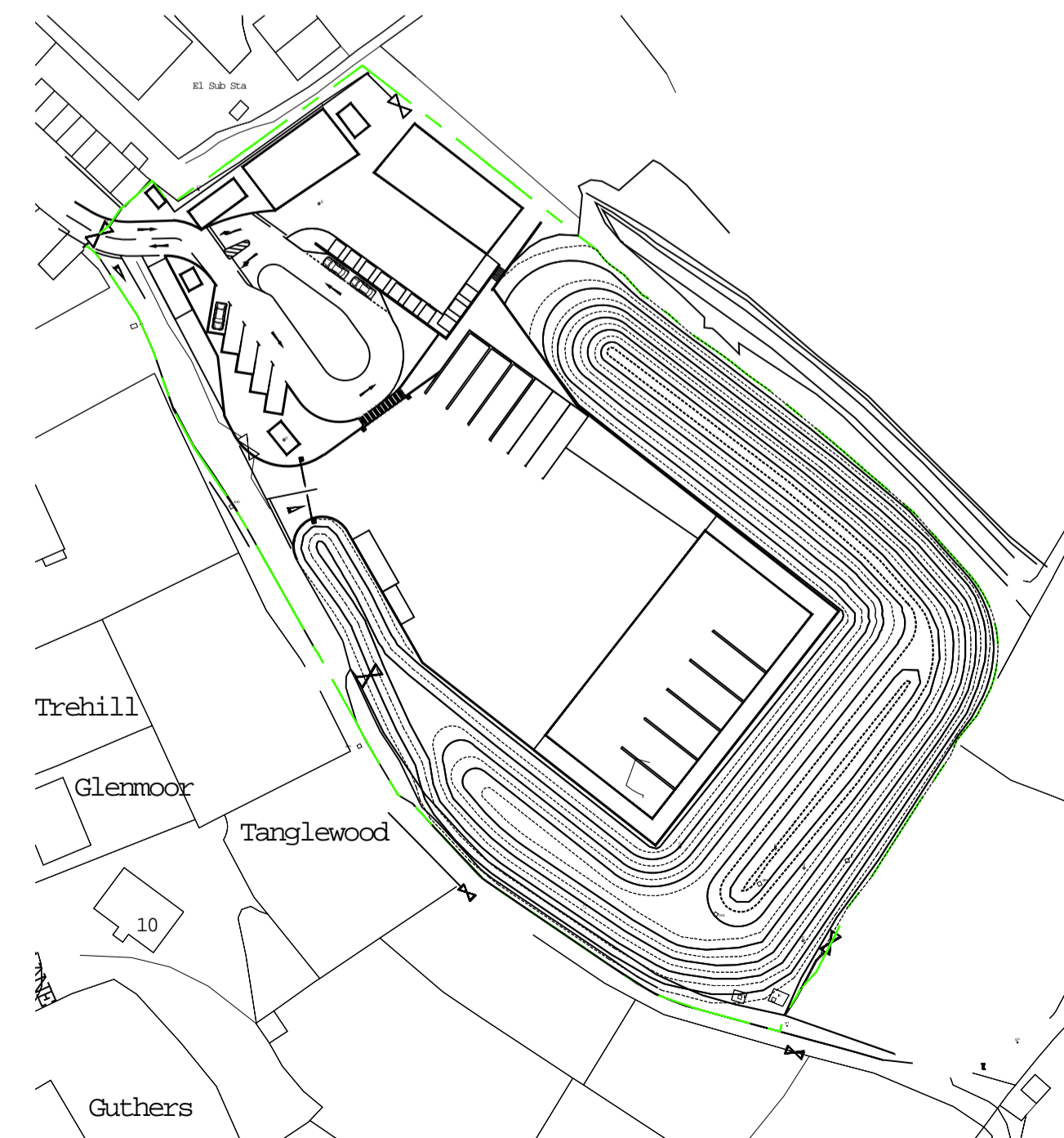

Proposed Site Layout Phasing Plan
Scale 1:1000

A FIRST ISSUE		TD	IM	12.06.15
Rev	Description	By	Clk	Date



Sherwood House,
Sherwood Avenue, Newark, Nottinghamshire, NG24 1QQ
T: +44 (0)1636 605 700 E: rpsnewark@rpsgroup.com

Client Council of the Isles of Scilly

Project Porthmellon Waste Management Facility, St. Mary's, Isles of Scilly

Title Engineering Layout - Phase 2

Status: PRELIMINARY
Scale: AS SHOWN @ A1
Date Created: 02.01.15

Project Leader: KMC
Drawn By: IM
Checked by:

Drawing Number: JKK8520 _06
Rev: A