

RECEIVED BY THE PLANNING DEPARTMENT

18 SEP 2017

GIBBSAN KYNE SHOP GARRISON LANE St. MARYS

Scale 1:1250

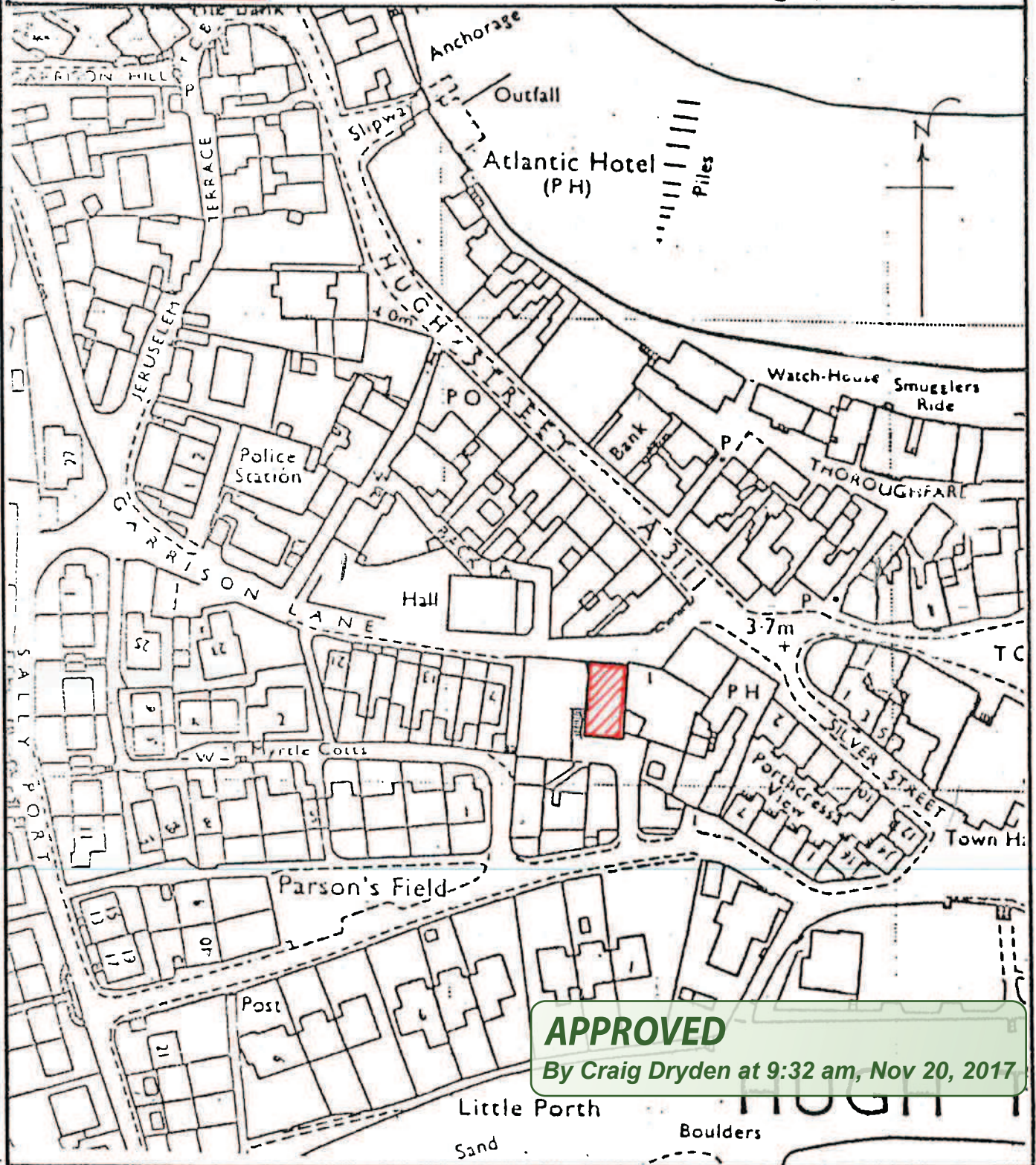

APPROVED
By Craig Dryden at 9:32 am, Nov 20, 2017

PROPOSED WHITE UPVC REPLACEMENTS

P-17-073

FRONT ELEVATION



APPROVED

By Craig Dryden at 9:33 am, Nov 20, 2017

REAR ELEVATION

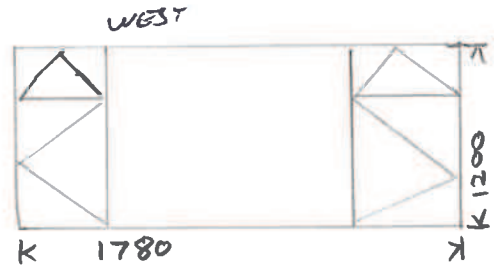
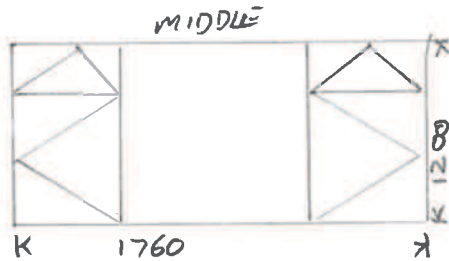
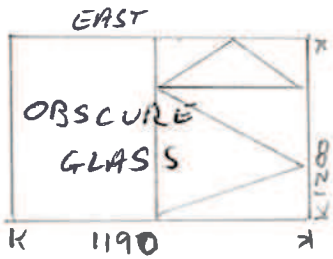

REAR SIDE (WEST)

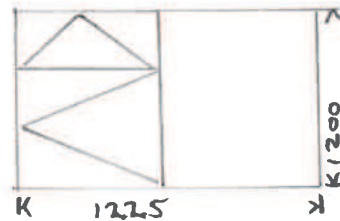

RECEIVED BY THE
PLANNING DEPARTMENT

18 SEP 2017



Proposed design of new UPVC windows

Gibson - Kyne

RECEIVED BY THE
PLANNING DEPARTMENT
30 AUG 2017