

1 Proposed Ground Floor
Scale: 1:100

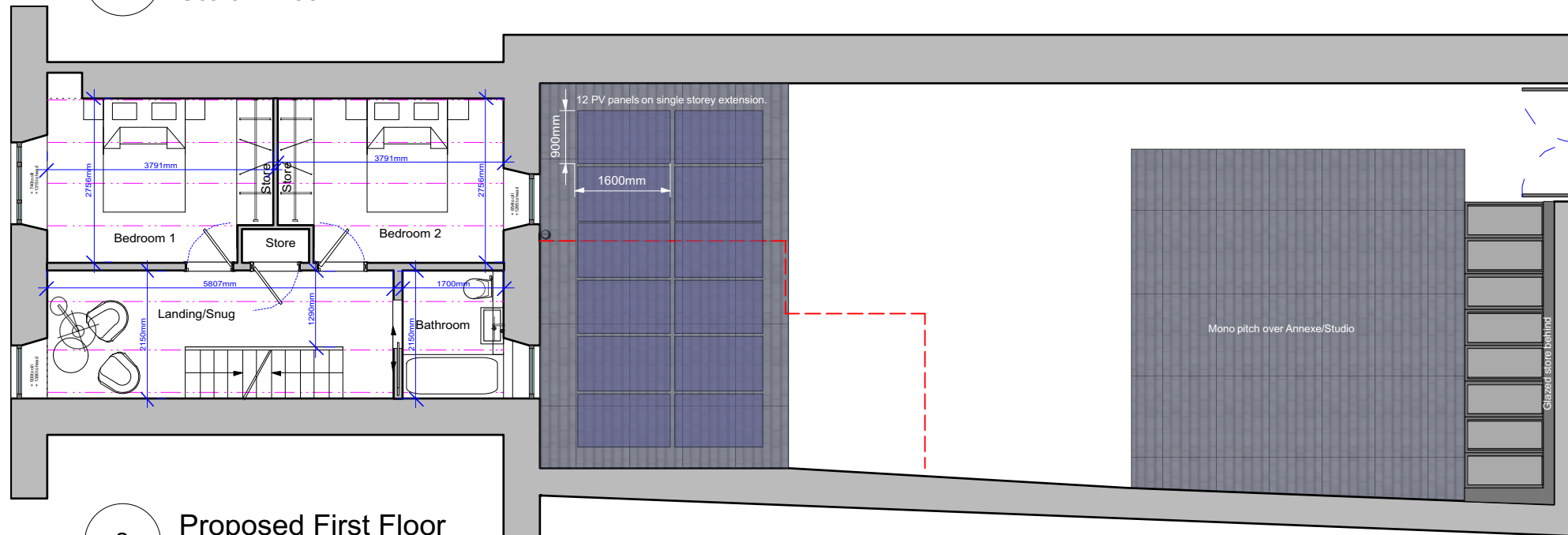

2 Proposed First Floor
Scale: 1:100

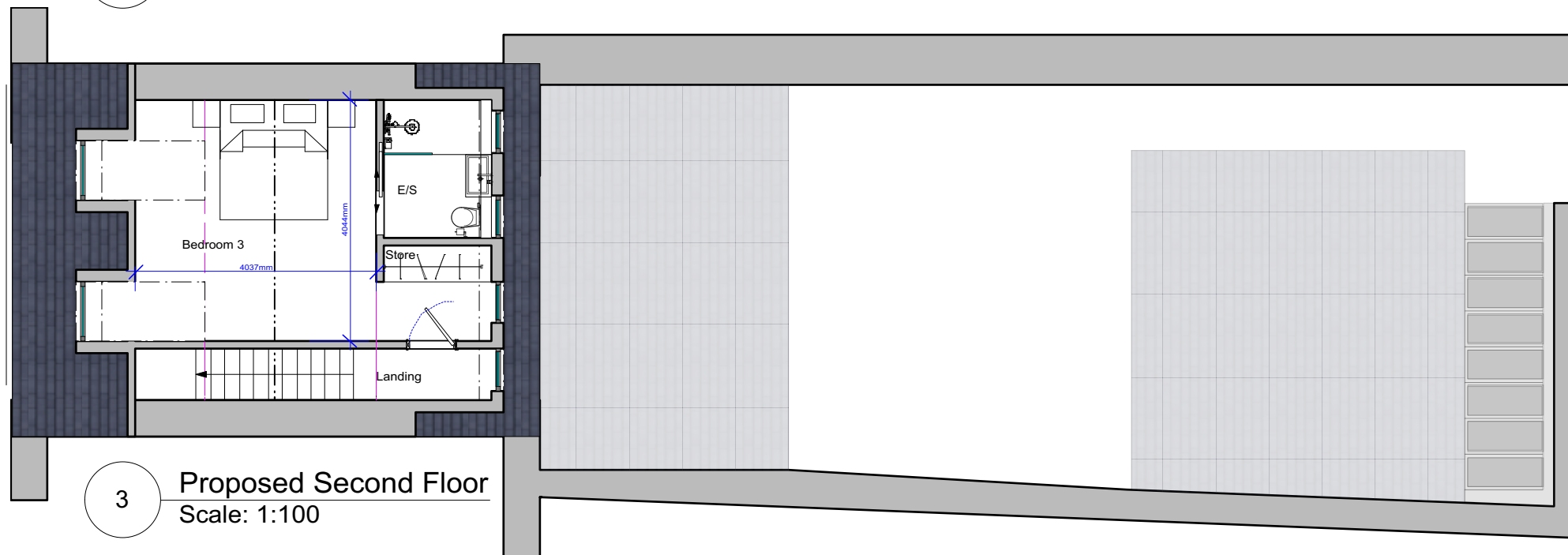

3 Proposed Second Floor
Scale: 1:100

GENERAL NOTES:
This drawing must not be copied in whole or in part without prior written permission of MATT BALL ARCHITECTURE. This drawing must be read in conjunction with other architect's drawings & all schedules/Building Bye-Law check list and with all relevant structural engineering drawings, details and specifications. It is the contractor's responsibility to ensure that all work is carried out in accordance with all statutory requirements and to the approval of the building control officer (B.C.O.) The contractor is responsible for the setting out of the works. Any discrepancy found between this drawing and any other architect's detail drawing, schedule and/or specification must be reported to the architect before the work is carried out. Do not scale from this drawing. Refer only to written dimensions. All dimensions must be checked on site. The relevant British Standards for materials and their uses are to be adhered to. Manufacturers installation & fitting instructions must be obtained and adhered to at all times.

REV	DESCRIPTION	DATE
1	Issue for Note	05.04.18

JOB TITLE
No.7 Lower Strand
Isles of Scilly
Extension & Alteration Works
For
Mr & Mrs Humphries

DRAWING TITLE
Planning Application
Proposed Floor Plans

DATE	DRAWING NO	REV
05.04.18	PP 02	
SCALE	DRAWN	
1:100 @ A3	M.BALL	