



FLATS 1, 2 & 6
MURKERS, GARRISON LANE,
ST MARY'S ISLES OF SCILLY.

GROUND FLOOR FLAT 6

FRONT DOOR
TO BE REINSTALLED
TO FLAT 5
THIS WINDOW TO BE REMOVED
AND TO BE BLOCKED UP

NEW WINDOW OPENING MADE
AND WINDOW TO BE INSTALLED.
THIS WINDOW TO BE REPLACED

THIS WINDOW
TO BE REPLACED

THIS WINDOW
TO BE REPLACED

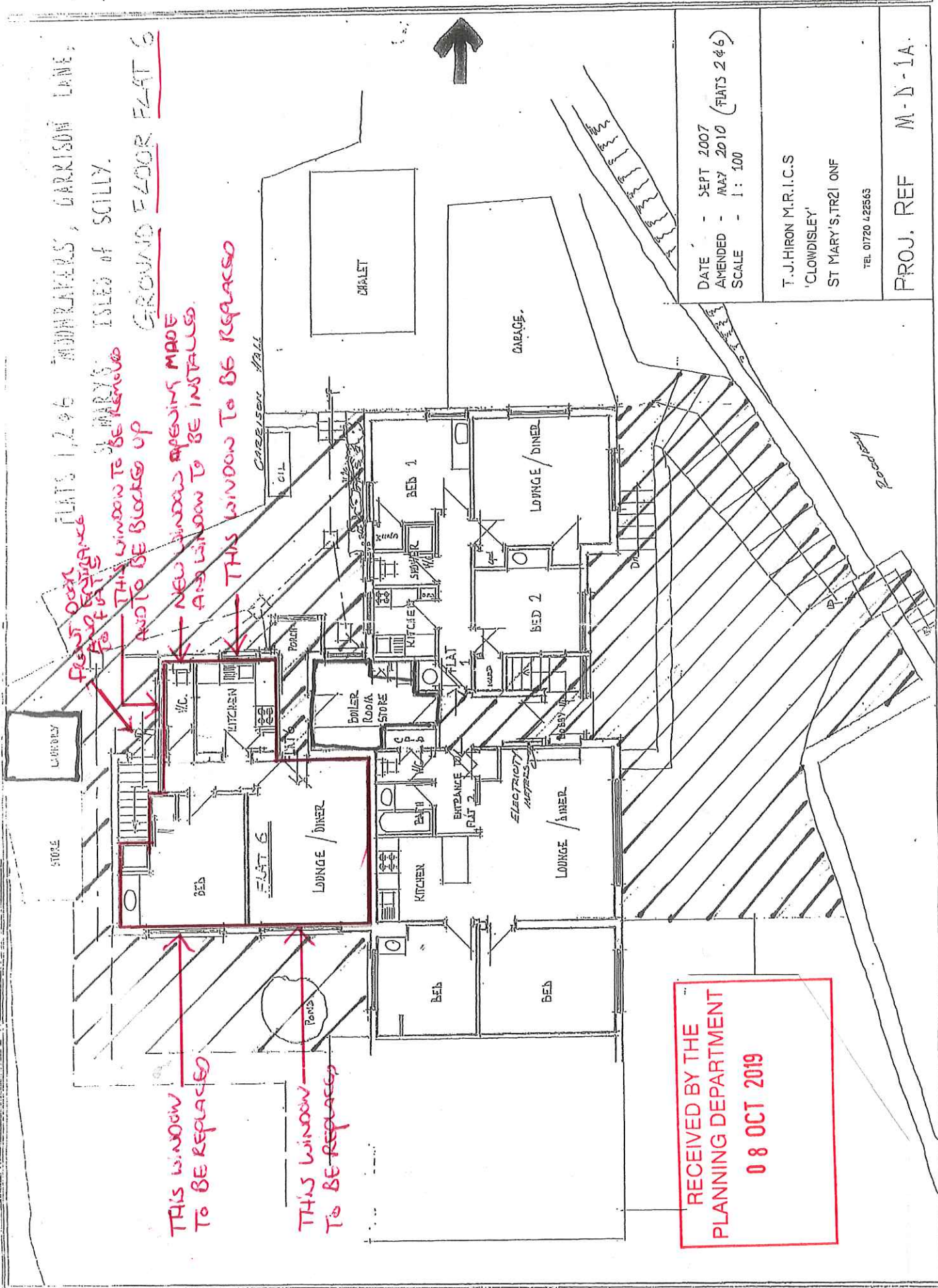

RECEIVED BY THE
PLANNING DEPARTMENT
08 OCT 2019

| | | |
|-----------------------|---|------------------------|
| DATE | - | SEPT 2007 |
| AMENDED | - | MAY 2010 (FLATS 2 & 6) |
| SCALE | - | 1:100 |
| T. J. HIRON M.R.I.C.S | | |
| 'CLOWDISLEY' | | |
| ST MARY'S, TR2 ONF | | |
| TEL: 01720 423563 | | |
| PROJ. REF | | M-D-1A. |