

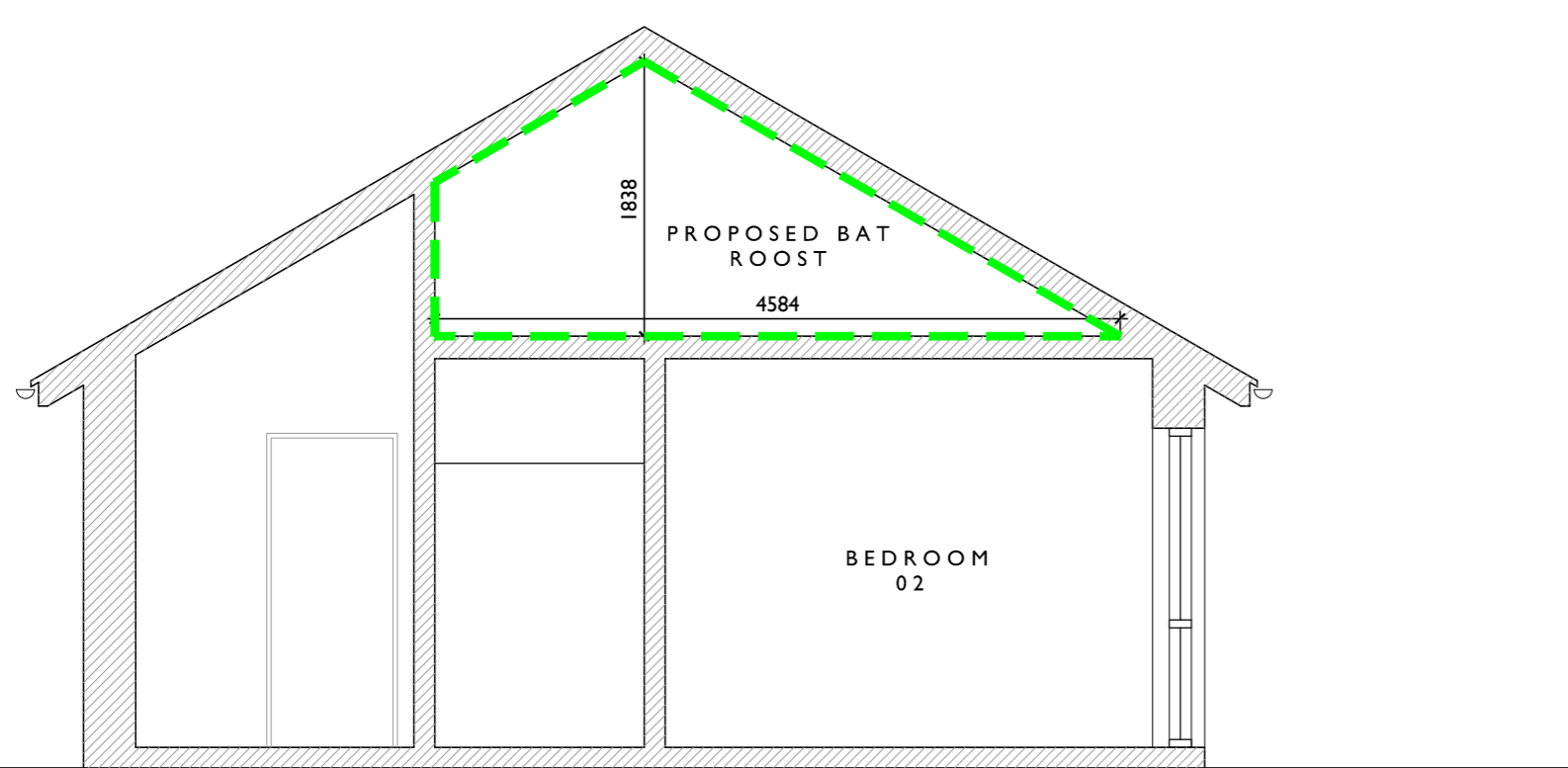

Proposed Bat Roost Location Plan



Proposed Bat Roost Section

Notes

- A roof void measuring c. 4m x 4m x 1.5m will be provided for day roosting brown long-eared bat with suitable bat access. To be lined with type IF bitumen.
- 2 temporary bat boxes (Schwegler IFF) will be installed on nearby trees prior to construction.
- A replacement day roost for common pipistrelle will be provided behind fascias in accordance with Bat Mitigation Plan.
- No exterior lighting will be installed close to the temporary and permanent bat roost features or access points.

Rev.	JW	NL	09/07/20	First Issue
DR.	DR.	CHK.	DR.	Notes
PROJECT RACKET TOWN				
DRAWING PROPOSED BAT MITIGATION				
DRAWING No. 3886 - 020				
DRAWING SIZE: 1:50 @ A1		DATE JULY 2020		
1:100 @ A3				

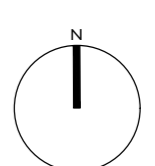

llewellyn
harker
lowe