

RECEIVED
By Emma Kingwell at 2:32 pm, Aug 21, 2020

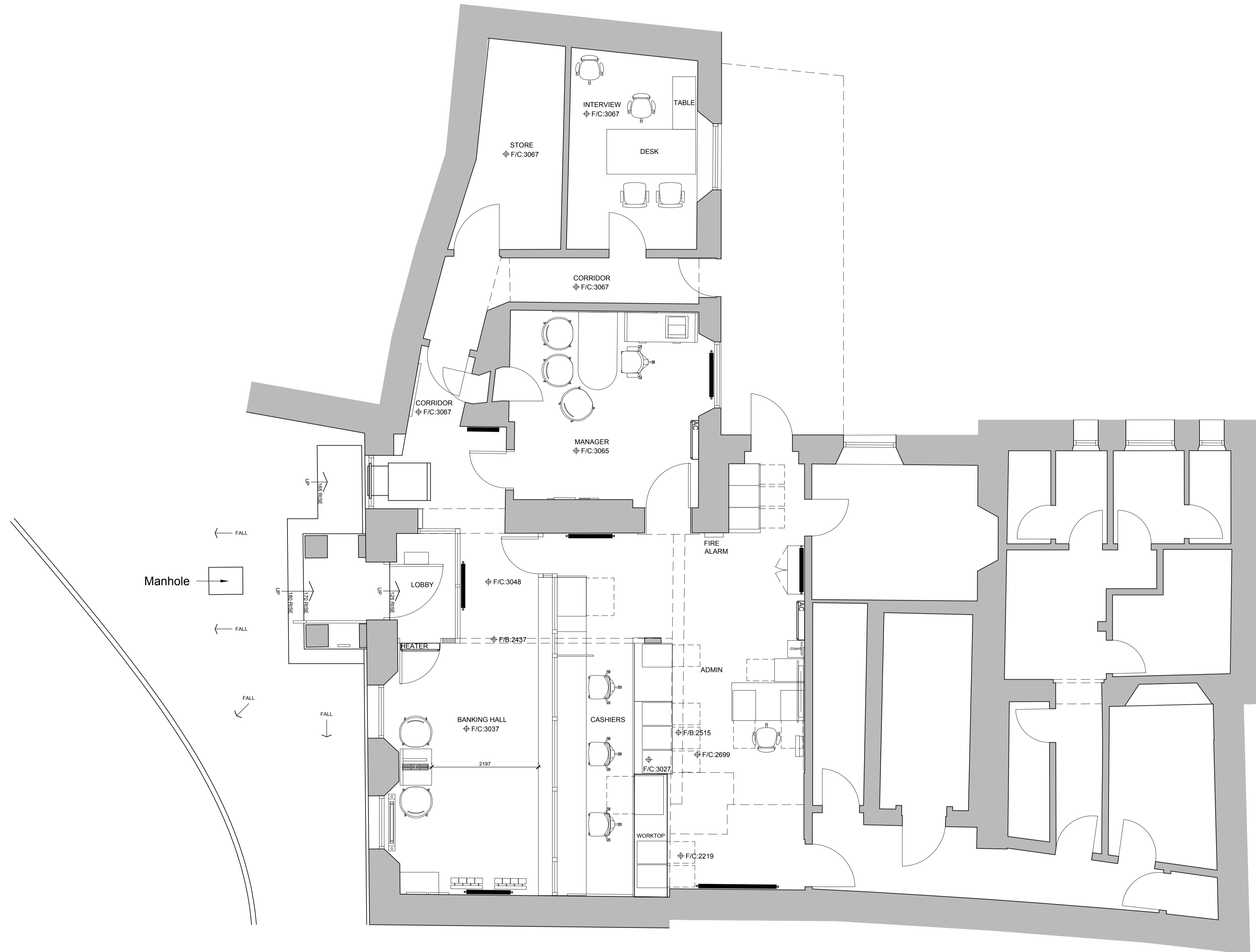
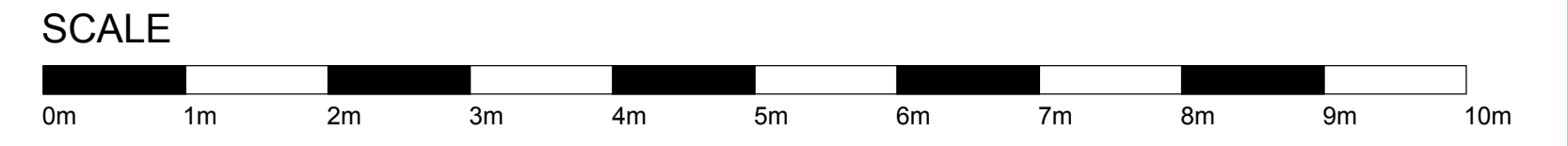

EXISTING GROUND FLOOR PLAN

REV	DATE	REVISION	INITIALS
LLOYDS BANKING GROUP			
ALL DIMENSIONS TO BE VERIFIED PRIOR TO COMMENCING WORK. DRAWING TO BE READ IN CONJUNCTION WITH PROJECT SPECIFICATIONS.			
THIS DRAWING IS THE PROPERTY OF LLOYDS BANKING GROUP AND COPYRIGHT IS RESERVED BY THEM. THE DRAWING IS ISSUED ON CONDITION THAT IT IS NOT COPIED OR DISCLOSED BY OR TO ANY UNAUTHORISED PERSONS WITHOUT PRIOR CONSENT IN WRITING TO LLOYDS BANKING GROUP - GROUP PROPERTY. ALL MODIFIED DRAWINGS SHOULD BE RETURNED TO LLOYDS BANKING GROUP.			
GROUP PROPERTY			
BRISTOL - PO Box 112, Canons House, Canons Way, BRISTOL, BS99 7LB EDINBURGH - Sighthill South, 12 Bankhead Crossway South, EDINBURGH, EH11 4EN HALIFAX - Trinity Road, HALIFAX, West Yorkshire, HX1 2RG			
PROJECT ADDRESS		SCALE	
Brand - Lloyds		A1 - 1:50	
St. Mary's Isles Of Scilly		A3 - 1:100	
P.O. Box 2		DATE	
ST MARY'S TR21 0PW		02/12/2019	
DRAWING DESCRIPTION		DRAWN BY	
Ground Floor			
Existing Plan			
DRAWING NUMBER		REVISION	
50252700-AREX-00-0001			