

RECEIVED
By Liv Rickman at 2:34 pm, Mar 02, 2023

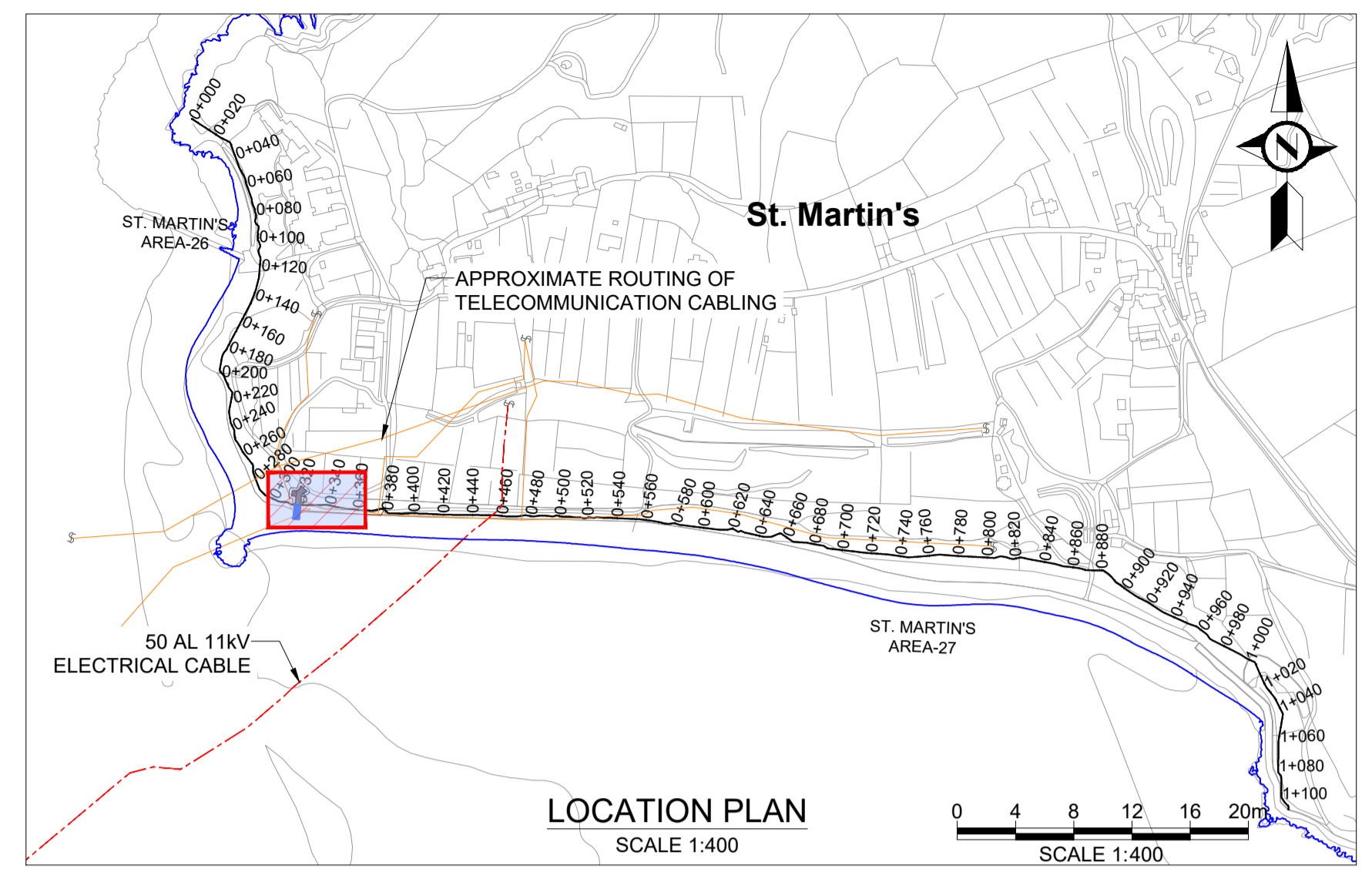

- ALL EXCAVATED MATERIAL TO BE SCREENED AND STOCKPILED.
- MATERIALS TO BE RE-USED ACCORDING TO SIZE.
 - GRANULAR MATERIAL WITH D50 BETWEEN 5MM AND 20MM TO BE PLACED AS OPEN GRID FILL.
 - GRANULAR MATERIAL WITH D50 BETWEEN 0.06MM AND 5MM TO BE PLACED ON BEACH IN LOCATIONS INSTRUCTED BY ENGINEER.
 - MATERIAL CONTAINING FINES WITH D50 LESS THAN 0.06MM TO BE DISPOSED LOCALLY. LOCATION TO BE INSTRUCTED BY THE ENGINEER

HAZARDS WARNING

1! PUBLIC ACCESS TO BEACHES
2! SOFT AND UNSTABLE MATERIALS
3! UNKNOWN LOCATION AND DEPTH OF TELECOMMUNICATION CABLES

© CROWN COPYRIGHT AND DATABASE RIGHTS 2022 OS 6119463

SP	Eastings	Northing	Elevation
SP1	91.5012	16.0205	
SP2	91.4978	16.0180	
SP3	91.4971	16.0114	
SP4	91.4971	16.0081	
SP5	91.4972	16.0077	
SP6	91.5520	16.0043	
SP7	91.5547	16.0085	
SP8	91.4909	16.0176	
SP9	91.4935	16.0172	
SP10	91.4929	16.0119	
SP11	91.4915	16.0124	
SP12	91.4967	16.0114	
SP13	91.4975	16.0181	
SP14	91.5011	16.0208	
SP15	91.4970	16.0246	
SP16	91.4943	16.0211	
SP17	91.4913	16.0214	
SP18	91.4909	16.0179	
SP19	91.4939	16.0176	
SP20	91.4933	16.0118	

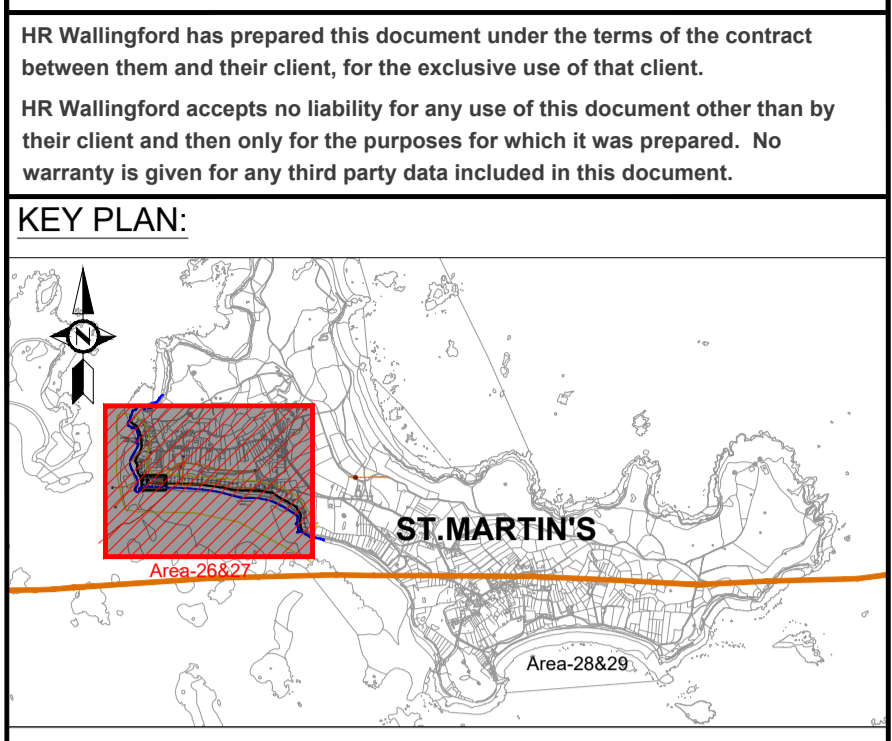

- NOTES:**
- ALL DIMENSIONS ARE IN METRES UNLESS STATED OTHERWISE.
 - HORIZONTAL DATUM IS REFERENCED TO OSGB 1936 BRITISH NATIONAL GRID.
 - VERTICAL DATUM IS IN METRES, ORDNANCE DATUM.
 - SETTING OUT POINTS TO BE AGREED FOLLOWING DETAILED SURVEYS.
 - ALL LEVELS TO BE CONFIRMED FOLLOWING ON SITE SURVEY.
 - ELECTRICAL CABLE ROUTING INFORMATION SUPPLIED BY WESTERN POWER DISTRIBUTION. TELEPHONE CABLE ROUTING SUPPLIED BY OPENREACH.
 - CABLE ROUTES AND DEPTHS SHOWN ARE APPROXIMATE ONLY. CONTRACTOR TO LOCATE AND PROTECT RELEVANT CABLING PRIOR TO WORKS.
 - EROSION PROTECTION SURFACING TO BE PROPRIETARY SURFACING PRODUCT, X-GRID BY KEDEL OR SIMILAR APPROVED.
 - [HTTPS://WWW.RECYCLEDPLASTICBUILDINGMATERIALS.CO.UK/ DRAINAGE-AND-GROUND-REINFORCEMENT.HTML](https://www.recycledplasticbuildingmaterials.co.uk/drainage-and-ground-reinforcement.html)
 - FOR GENERAL NOTES REFER TO DRAWING No. DKR6499-000-D102.
 - FOR SECTIONS REFER TO DRAWING No. DKR6499-310-D310.
 - REMOVABLE SLIPWAY BY TRACKWAY OR SIMILAR APPROVED PRODUCT [HTTPS://FAUNTRACKWAY.CO.UK/ACCESS/BOAT-RAMP-KIT](https://fauntrackway.co.uk/access/boat-ramp-kit). TO BE SUPPLIED WITH PUSHBAR AND STAPS.
 - 2020 LIDAR DATA ADJUSTED TO 2011 BASELINE TO BRING IN LINE WITH JBA WAVES STUDY.
 - © CROWN COPYRIGHT AND DATABASE RIGHTS 2022 OS 6119463

- LEGEND:**
- SURFACING AREA
 - DUNE FENCING
 - REMOVABLE SLIPWAY
 - MHWS=2.77 mOD
 - TELECOMMUNICATIONS CABLES
 - ELECTRICITY CABLES

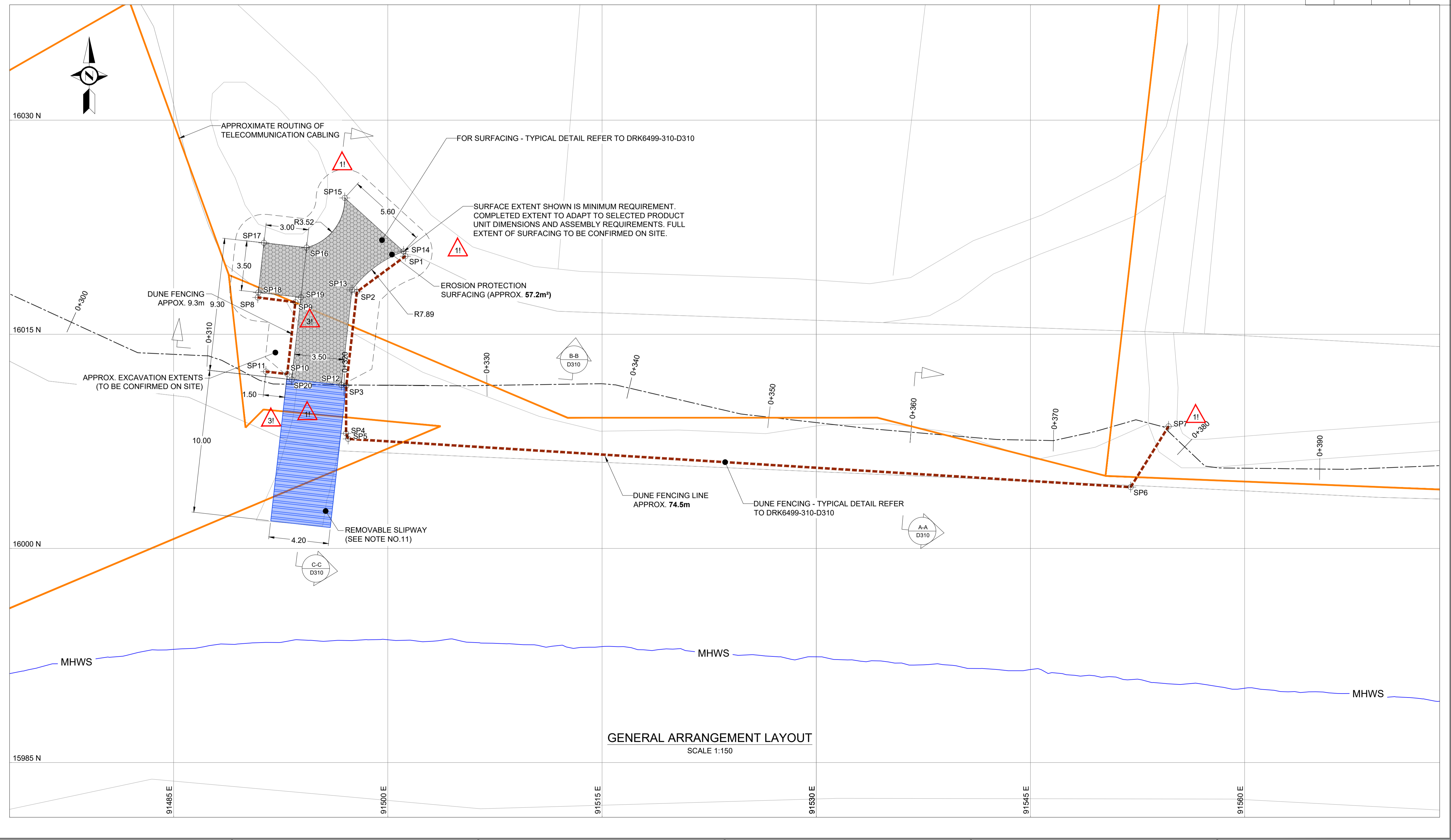
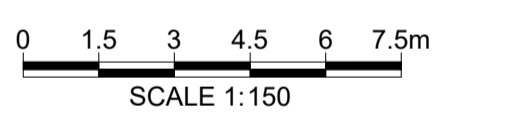

02	ISSUED FOR CONSTRUCTION	TGM	AGC	AUO	10 FEB 23
01	ISSUED FOR REVIEW	PGU	AGC	AUO	10 AUG 22
REV	DRAWING STATUS	DRN	APPR	AUTH.	DATE

CLIENT:
THE COUNCIL OF THE ISLES OF SCILLY

MARINE CONSULTANT:
HR Wallingford
Howbery Park, Wallingford
Oxfordshire OX10 8BA
United Kingdom
Tel: +44(0)1491 835381
Fax: +44(0)1491 832233
www.hrwallingford.com

PROJECT:
**ISLES OF SCILLY
DESIGN SERVICES FOR OFF ISLANDS
COASTAL EROSION DEFENCE AND
DUNE MANAGEMENT**

DRAWING TITLE:
**ST. MARTIN'S - 26&27
GENERAL ARRANGEMENT LAYOUT**

SCALE: AS SHOWN SHEET SIZE: A1
DRAWING No: DKR6499-310-D110 REV: 02

10/02/23 TGM \\hrw\uk\local\projects\live\dkr6499-310-D110 [02]_General Arrangements-St. Martin's 26&27_02_02.dwg