





**External Surfaces Key:**

-  Concrete
-  Gravel
-  Grass
-  Earth/Plant Bed

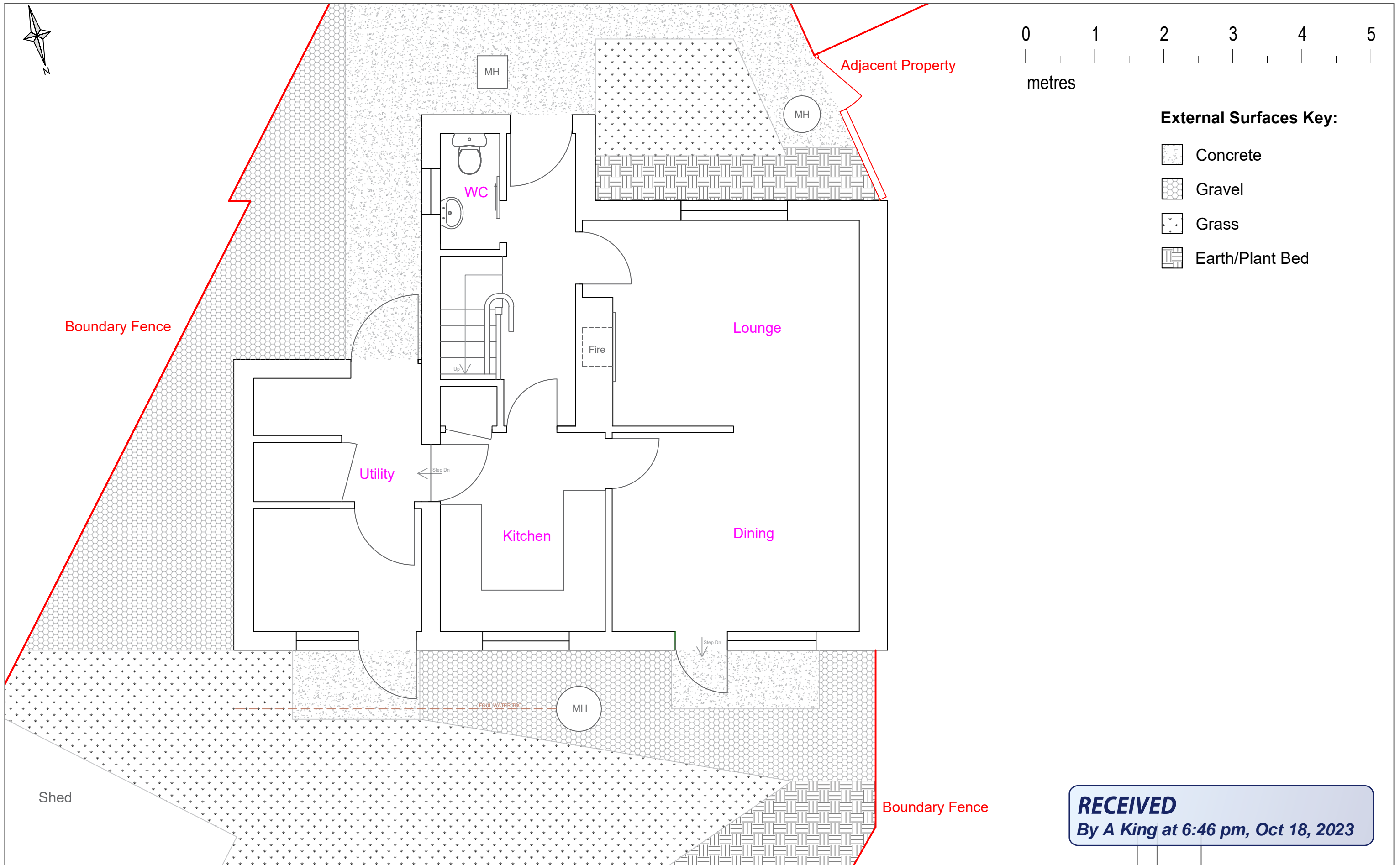

**RECEIVED**  
 By A King at 6:46 pm, Oct 18, 2023

**Currie & Brown**  
 Poseidon House, Neptune Park,  
 Maxwell Road, Plymouth, PL4 0SN  
 United Kingdom  
 Tel: 01752 273473 , Fax: 01752 257755, www.curriebrown.com

Client  
**Council of the Isles of Scilly**

Title  
**Existing Ground Floor Plan**

Project  
**3 Ennor Close - Accessibility Improvements**

Date	02.10.2023	Drawn	AH
Scale	1.50 @A3	Checked	KC
Drwg No.	4101565-3E-PL-01		
Rev			