

RECEIVED

By Liv Rickman at 12:01 pm, Mar 12, 2024

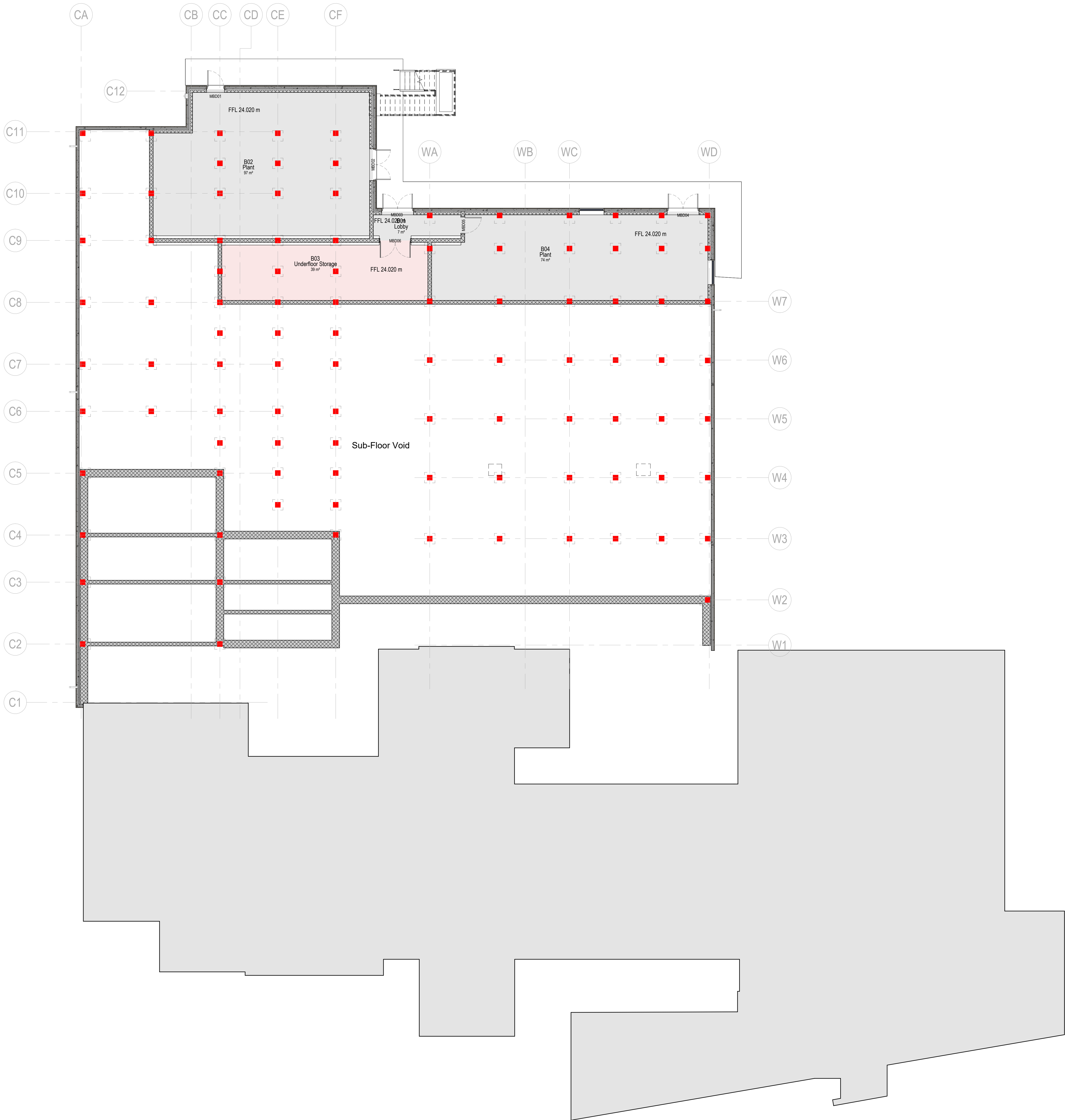

Proposed Lower Ground Floor
Plan
1 : 100

Notes

This drawing is the property of Blue Sky Design Services Ltd and copyright is reserved by them. This drawing is not to be copied or disclosed by or to any unauthorised persons without the prior written consent of Blue Sky Design Services Ltd.

All dimensions are to be checked on site prior to construction, manufacture of any components and ordering of materials and equipment.

Any discrepancies are to be reported to the architect for clarification.

All materials and workmanship to be in accordance with the current British Standards and codes of practice.

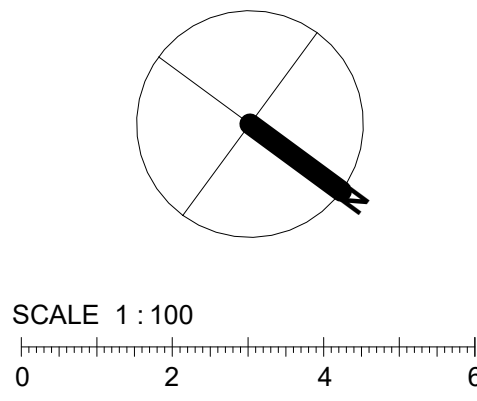

P01 11.03.24 RW AQ Roof height dropped, walkway omitted, external staircase relocated & entrance door reduced to single leaf to meet Part M compliance.

Rev	Date	By	Chk	Comments				
Client								
Cornwall Partnership NHS Foundation Trust								
Project								
Isles of Scilly Enabling Works								
Drawing								
Proposed Lower Ground Floor Plan								
Revision				Purpose				
P01				Preliminary				
Drawing Number		project	originator	zone	level	type	role	number
23010		BBA	ZZ	LG	DR	A		2005
BSDS Job No.		Scale			Date			
23010-04		1:100 @ A0						
Suitability		Suitability Description						
S4		Planning Issue						
Drawn By		Checked By						
RW		AQ						

bluesky capra
architects architects

Building 1000, Kings Reach, New Street, Stockport, SK4 2HG
0161 475 0205
info@blueskyarchitects.co.uk
www.blueskyarchitects.co.uk
0161 368 1101
enquiries@capra-architects.co.uk
www.capra-architects.co.uk